

YACHT

SANLORENZO

SP
110/

SP
110/



SP
110/



SP
110/



SP
110/



SP
110/



SP
110/



SP
110/



SP 110/



SP
110/



SP
110/



SP
110/



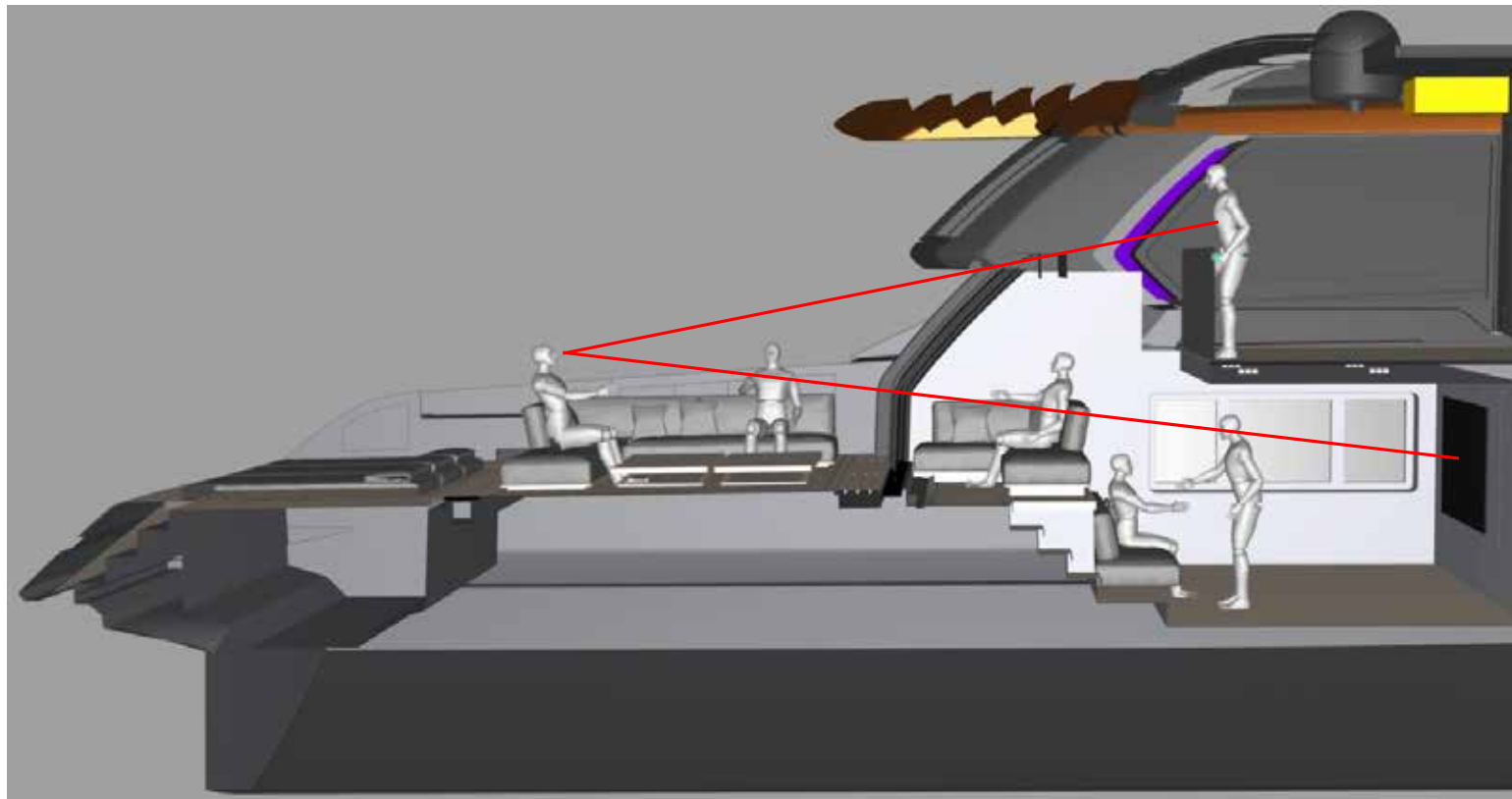

SP
110/



SP
110/



SP
110/



SP
110/



SP
110/



SP
110/



SP
110/



SP
110/

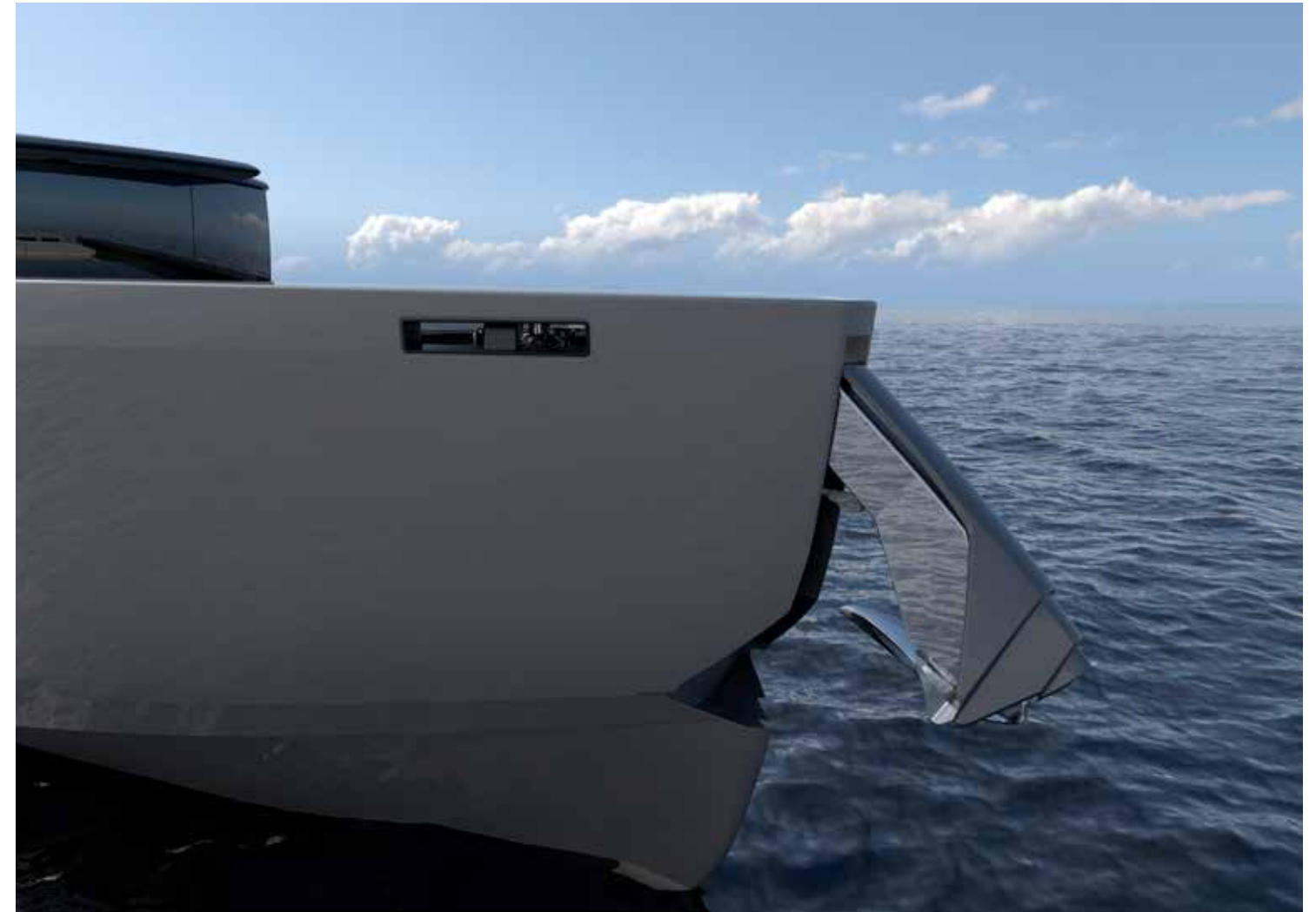

SP 110/

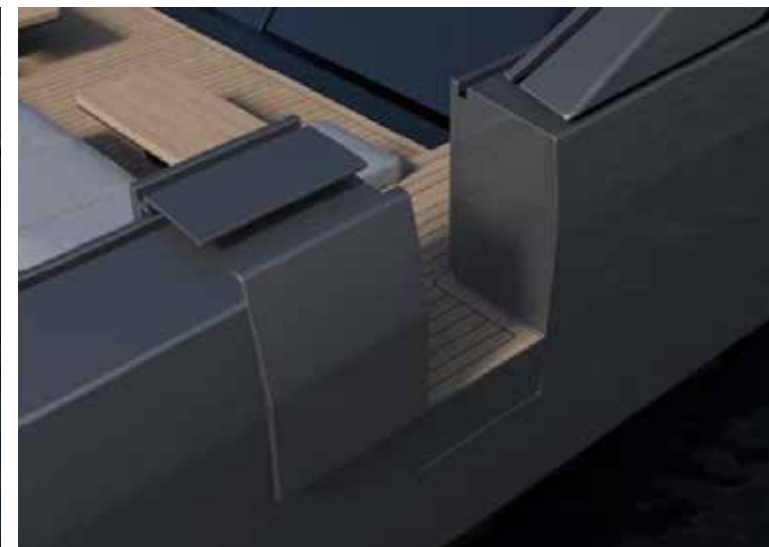
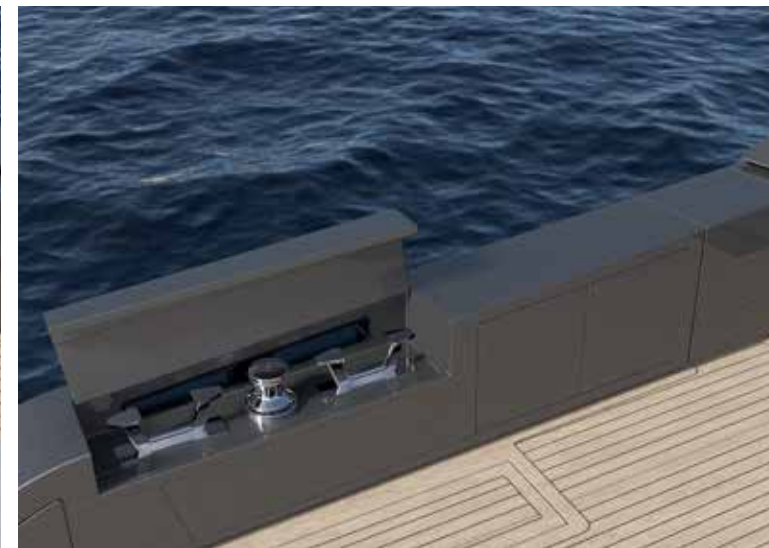
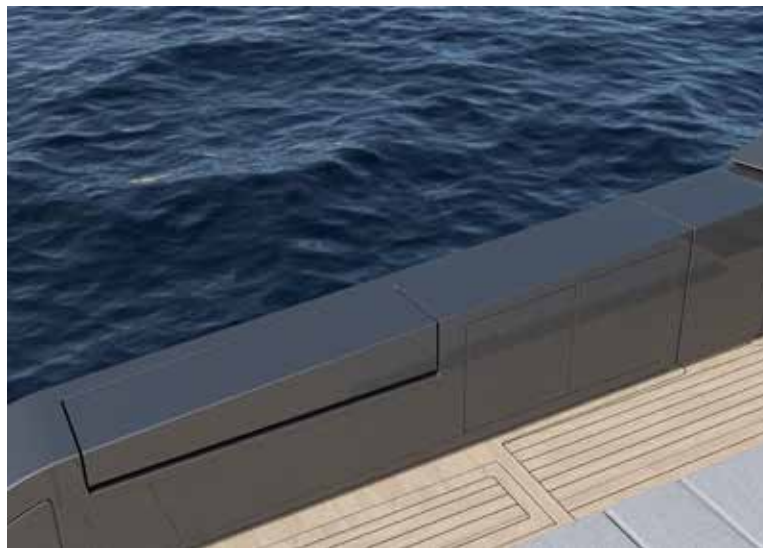
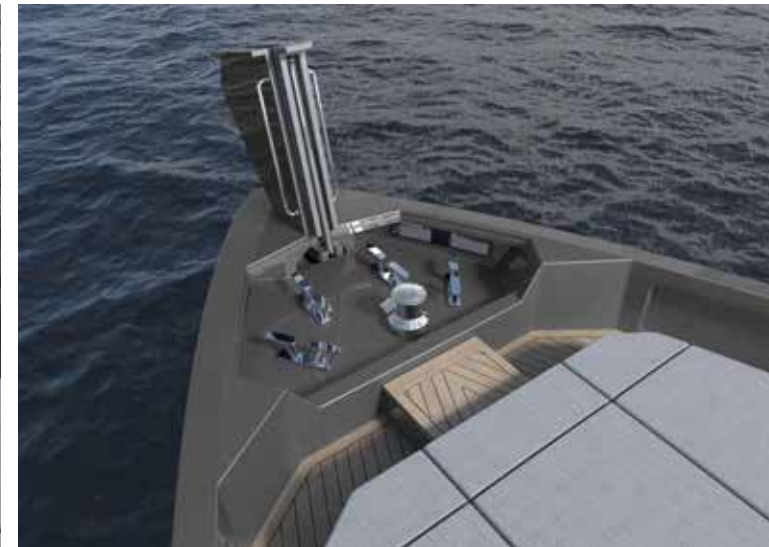
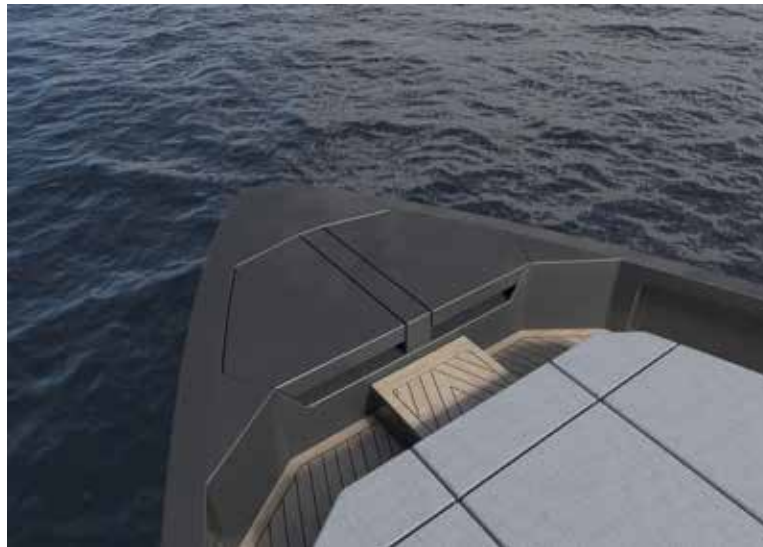

SP
110/



SP
110/



SP
110/



SP
110/













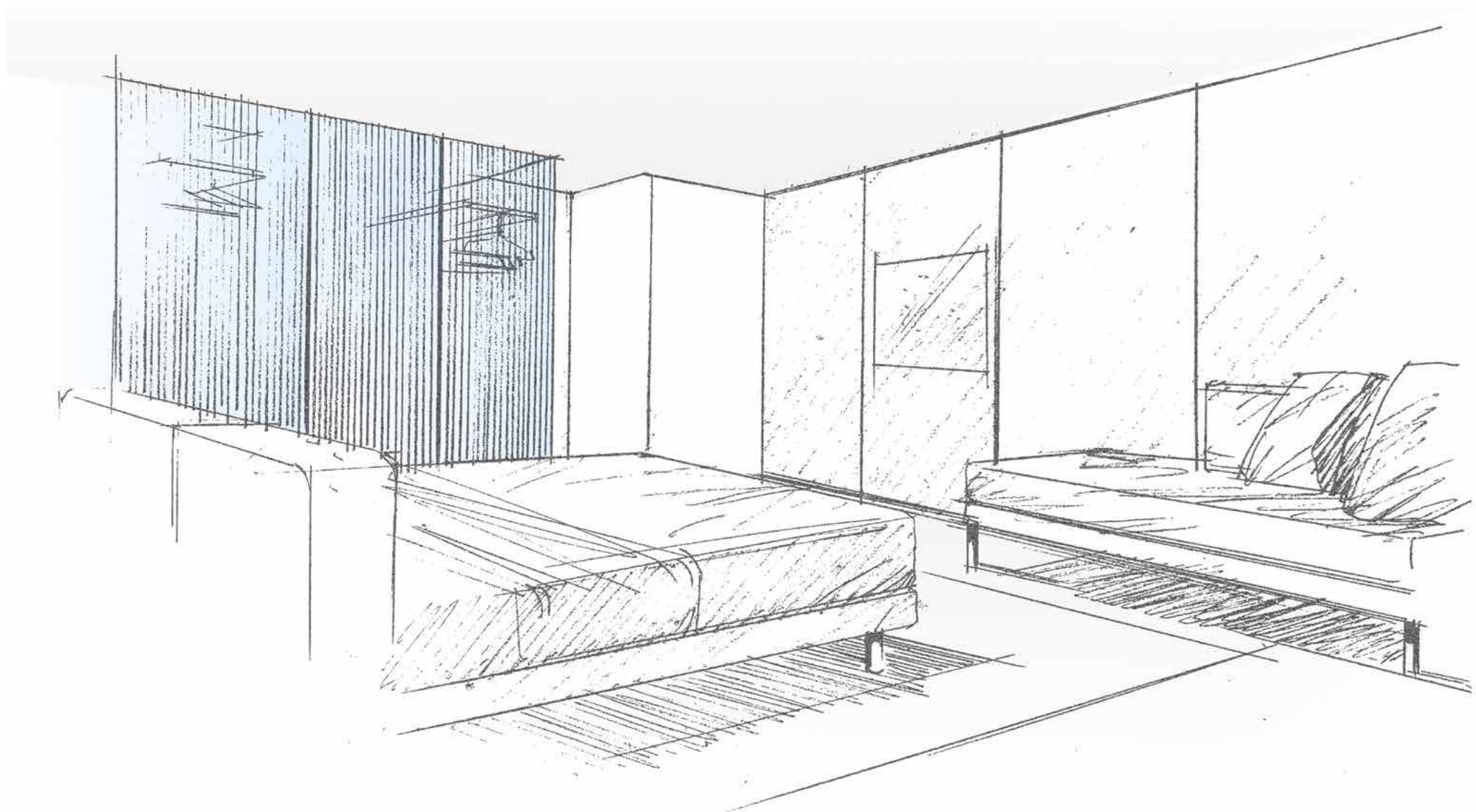





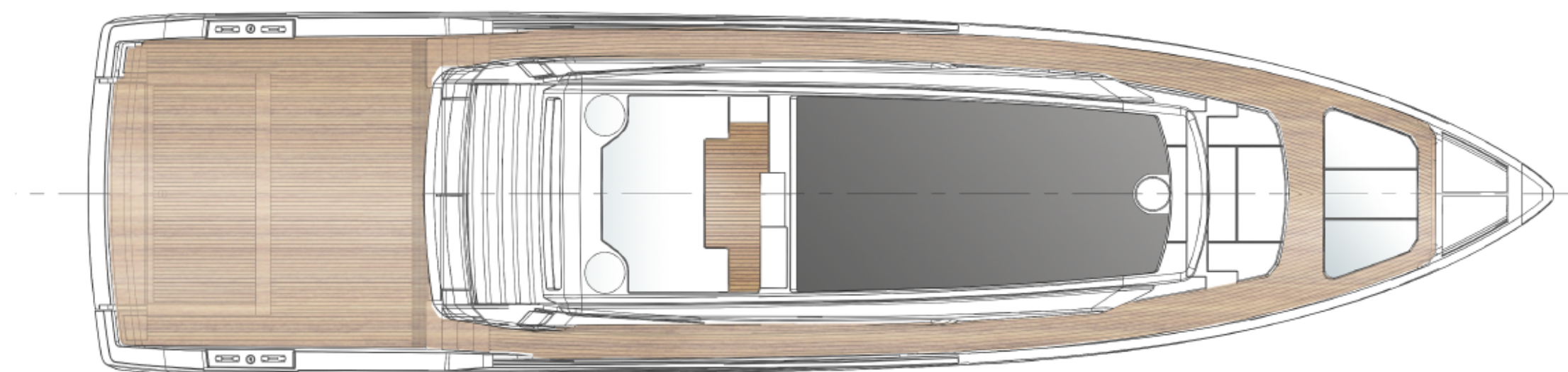
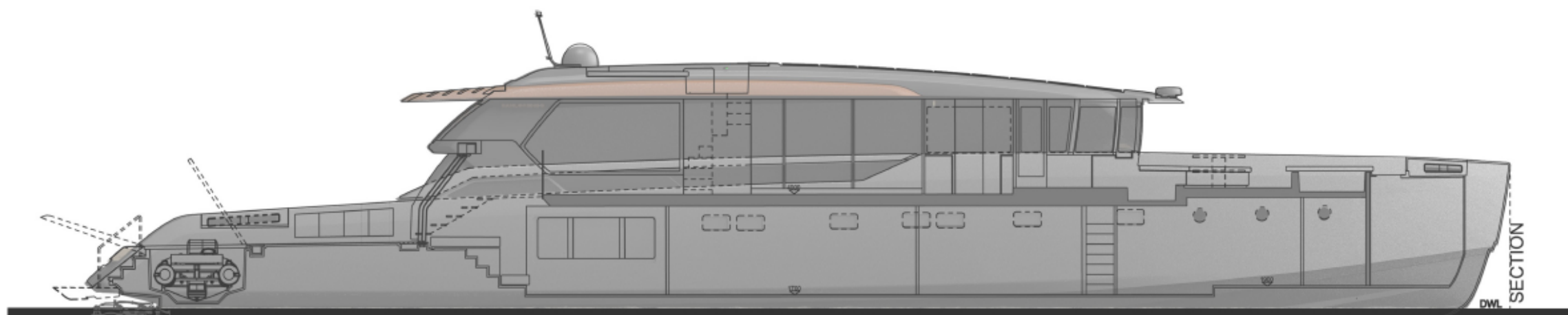

Standard layout

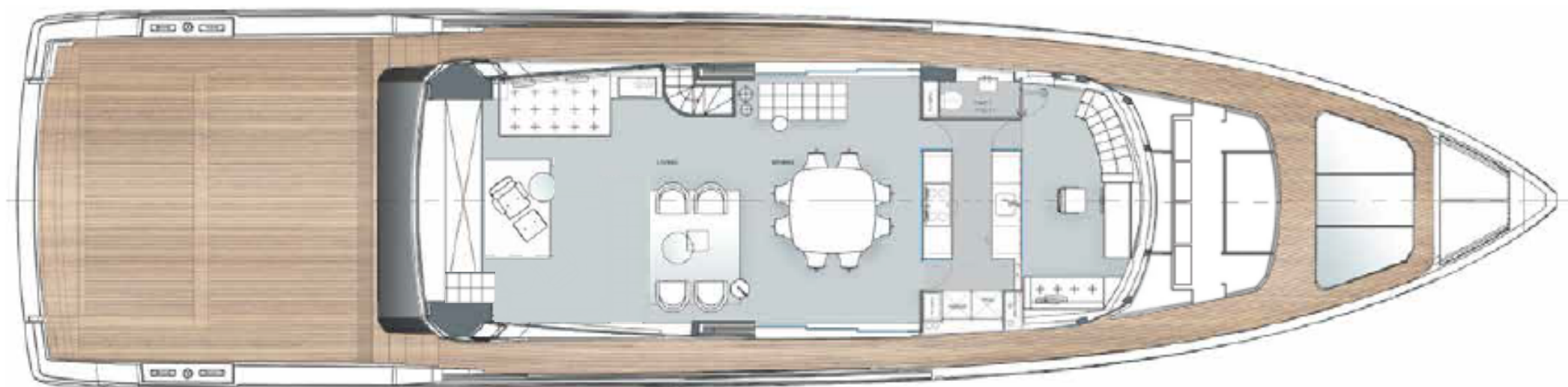

Also available in 4-cabin layout

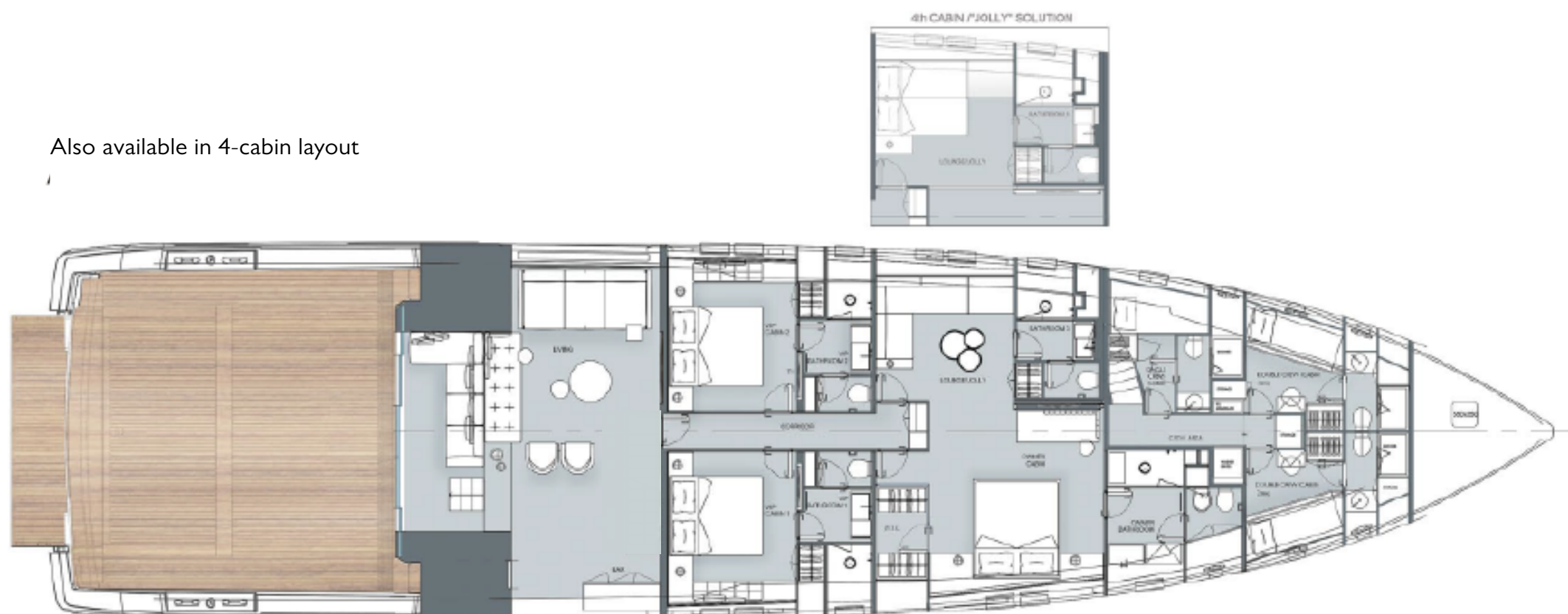

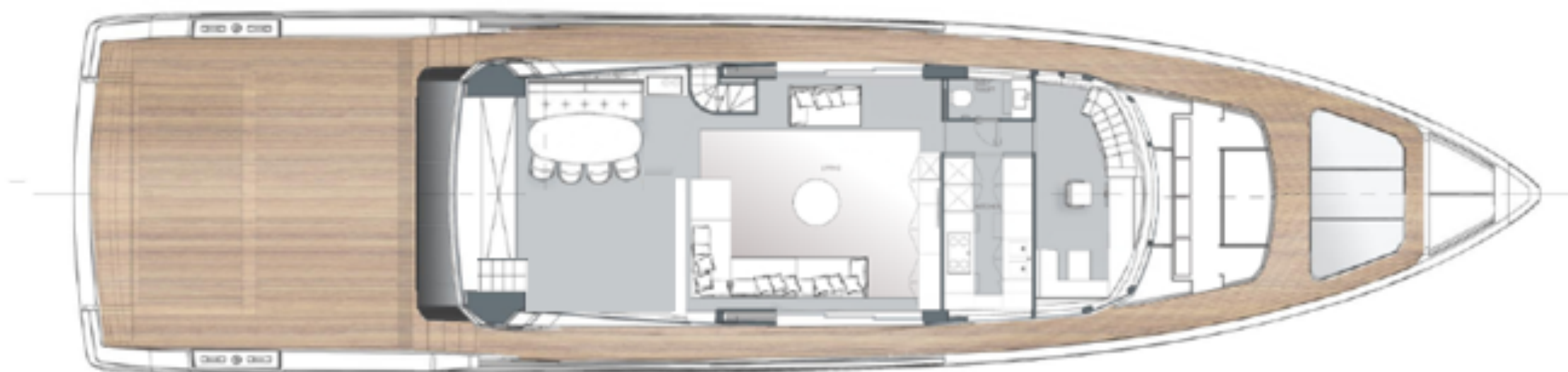

Also available in 4-cabin layout

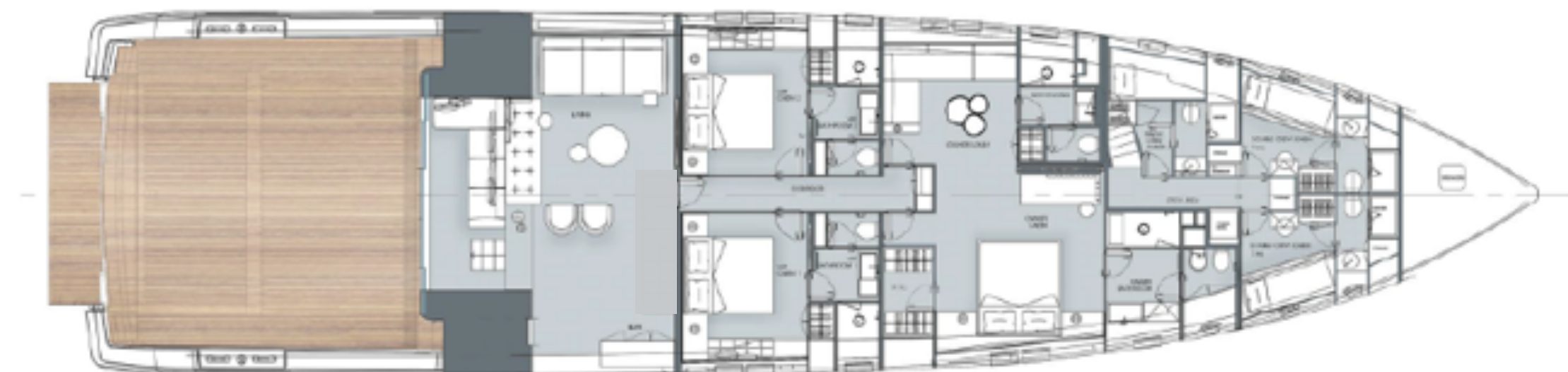

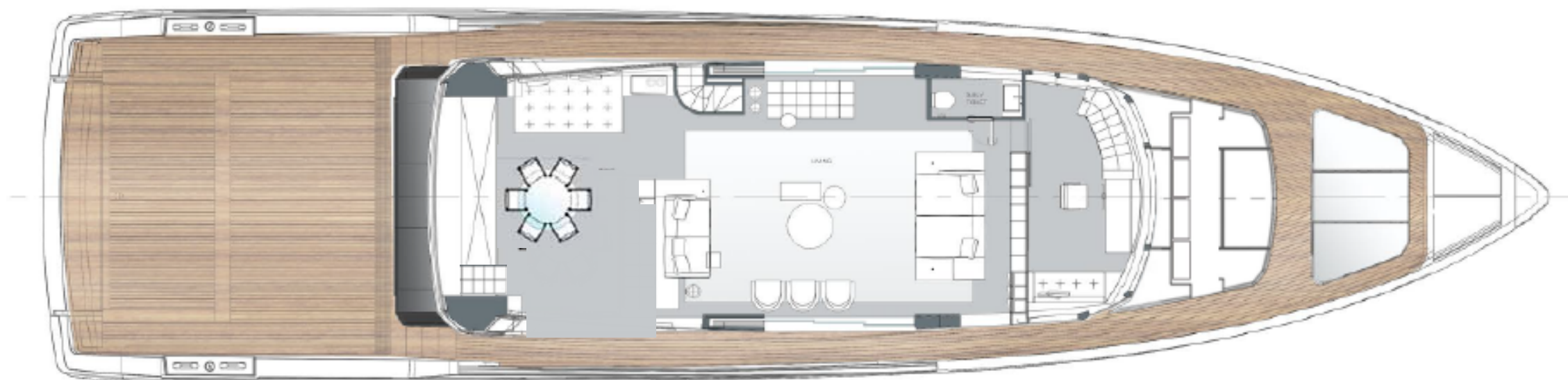

Also available in 3-cabin layout

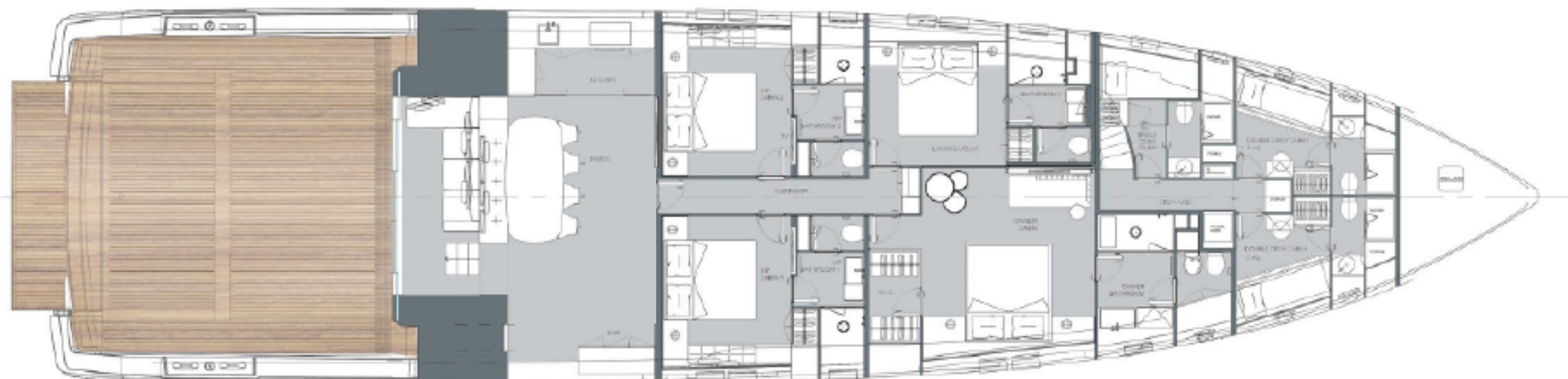

Solution A

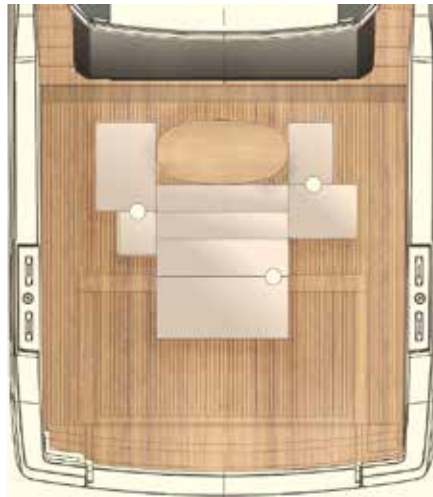

Solution B

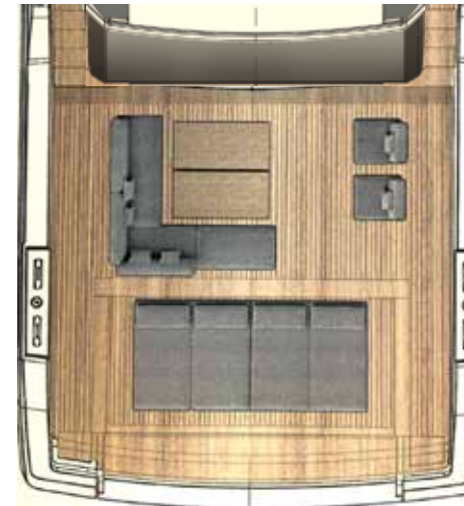

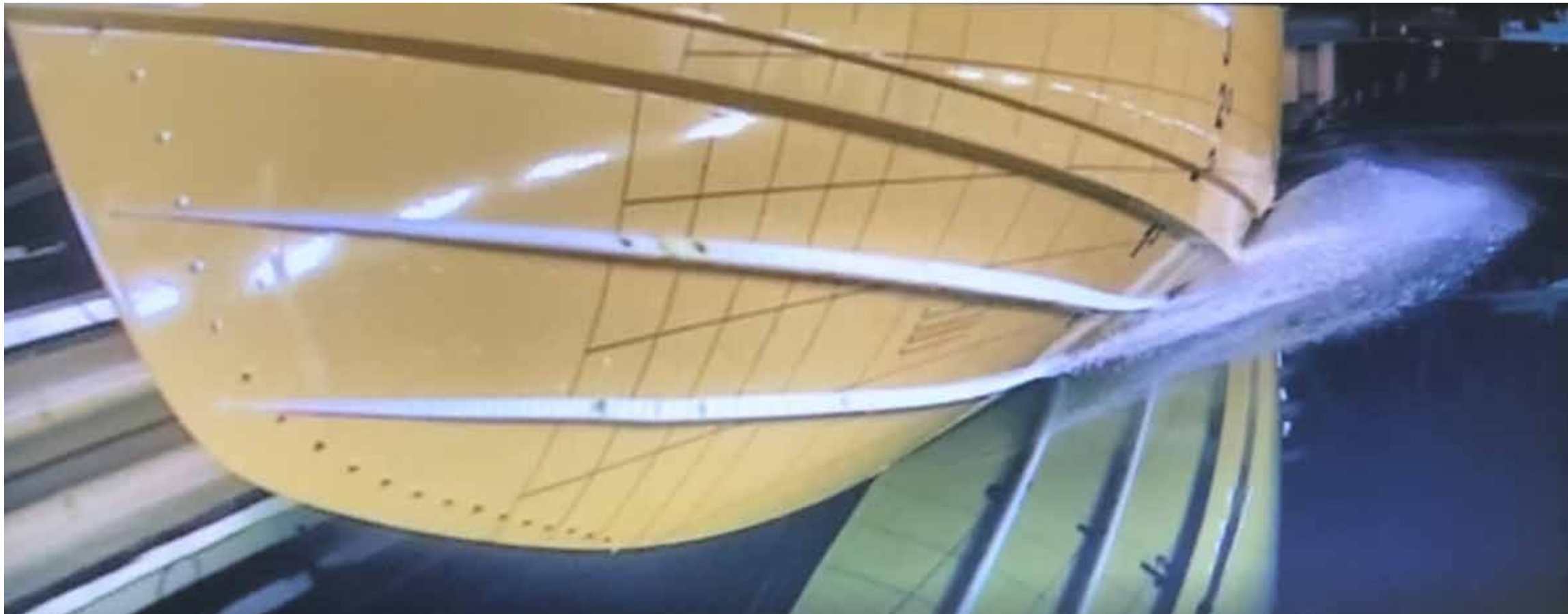

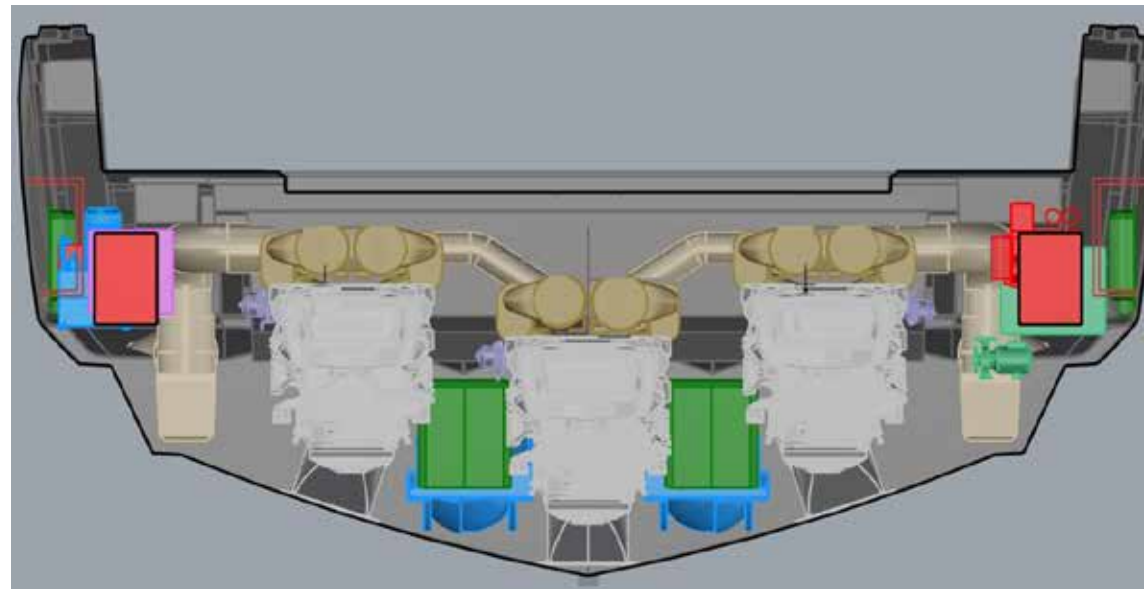

SP
110/

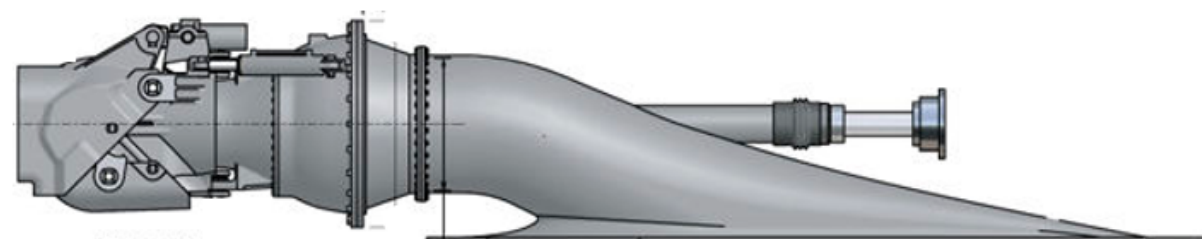

MJP

A FORCE TO TRUST

CSU series 550

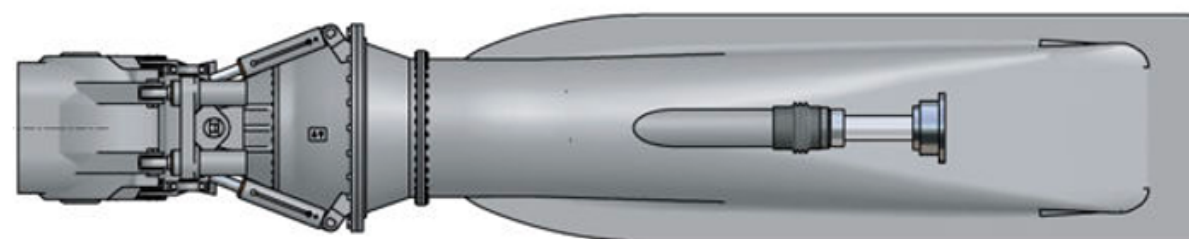

Sustainable Performance

MONOCRISTALLINE SOLAR PANNEL



In the Mediterranean waters, in a summer day, about 62 kW/h will be produced to run the hotels loads (average 15kW/h) for more than 4 Hours **FOR FREE EVERYDAY**

Sustainable Performance

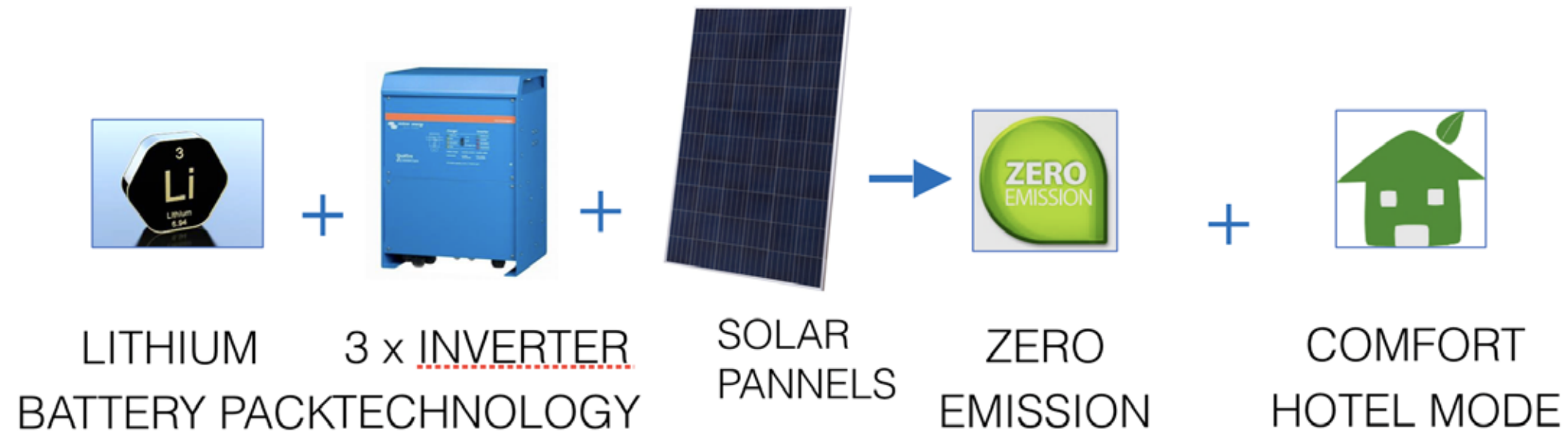

| | |
|--|--|
| Length overall | 33,04 m |
| Length overall with open swimming platform | 33,84 m |
| Maximum beam | 8,20 m |
| Displacement @ half load (*) | 102 t +/- 3% |
| Waterline length @ half load | 29,77 m |
| Draught @ full load | 1,35 m |
| Engine | 3 x MAN LE436V12 - 1800 HP (OPT 3 x MAN V12 – 2000 HP) |
| Propulsion | 3 x water jet MJP 550 + Booster centrale |
| Gensets | 1 x 28 kW + 1 x 35 kW Kohler |
| Bow thruster | Electric-hydraulic |
| Lithium battery package | 2 x 60 kWa lithium battery pack (OPT) |
| Maximum speed (approx.) (**) | 36 kn +/-5% (40 kn +/-5% MAN 2000 HP) |
| Cruising speed (approx.) (**) | 32 kn +/-5% (36 +/-5% MAN 1800 HP) |
| Economical speed (approx.) (**) | 2500 nm @ 10 kn (preliminary) |
| Max range @ economical speed (approx.) | 470 nm (410 nm 2000 HP) |
| Fuel capacity | 12000 l |
| Fresh water capacity | 1500 l |
| Black water capacity | 400 l |
| Grey water capacity | 600 l |



* Displacement data refers to a yacht with standard layout as described in the sales specification
** Speed data refer to a yacht with standard layout as described in the sales specification, considering calm sea and no wind, and a third of liquid weight, a third of luggage weight (25kg per bed) and 5 crew members (80kg each).

Where comfort meets speed

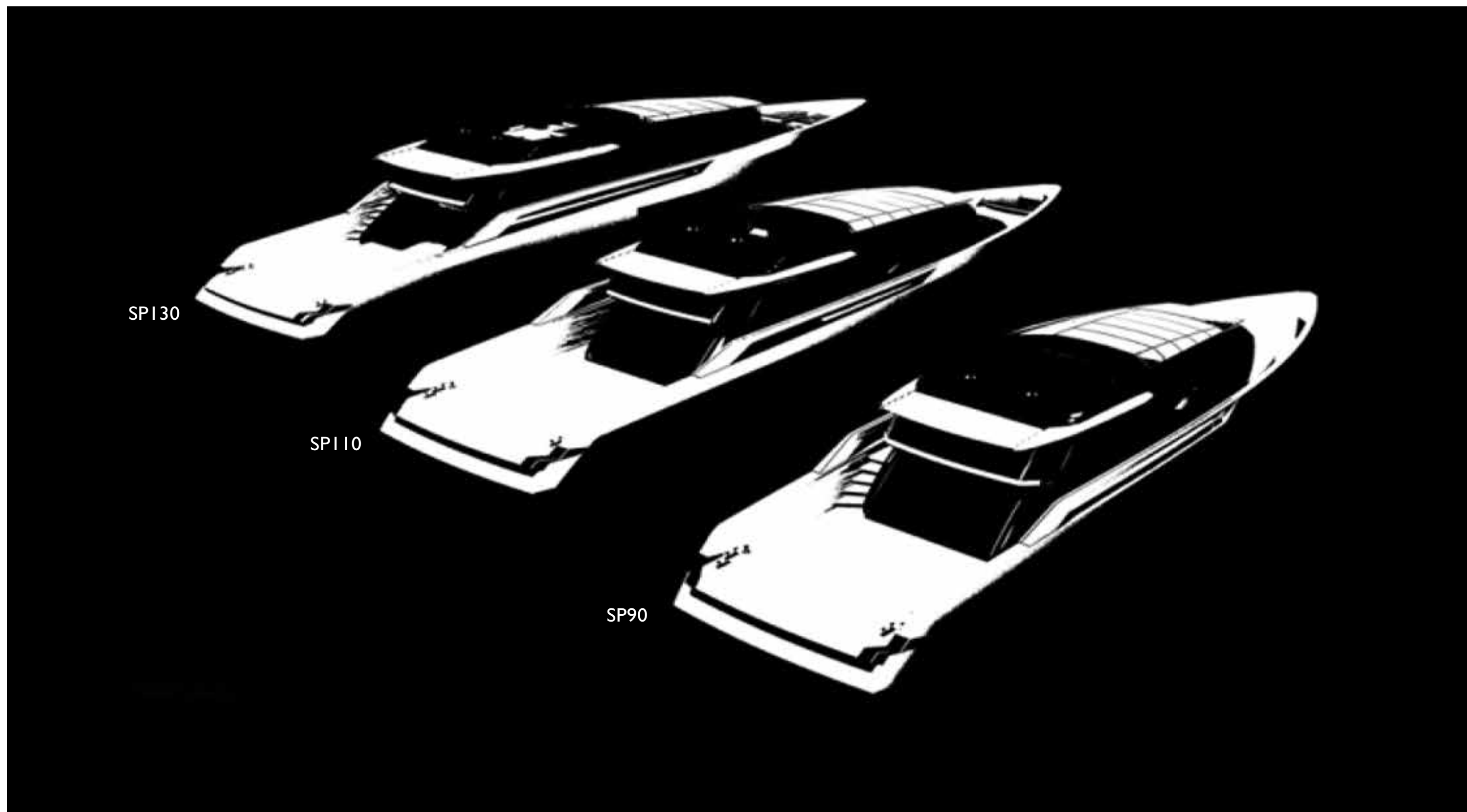
SP
110/

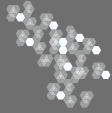

It's not an investment if it's destroying the planet

| | | | | | | | | | | | |
|---|---|---|---|---|---|---|---|---|---|---|---|
|  |  |  |  |  |  |  |  |  |  |  |  |
| INFUSION LAYUP SYSTEM | BIO RESIN &CORE | FSC CER TIFIED WOOD SUPPLY | FORMALDEHYD E FREE FURNITURE | LED LIGHTING | BIOCHROME® | SUSTAINABLE LEATHER | CLASS A++ | SOLAR PANELS | HULL EFFICIENCY | THERMAL INSULATION | PROPULSION EFFICIENCY |

This brochure shall not be regarded as a contractual offer regarding the sale of yachts from the shipyard to individuals or companies. All the information contained in this brochure, including without limitation any technical or performance data, pictures, and drawings, are mere indications with no contractual value.

This document is based on the information available at the time it is published. In spite of the commitment aimed at guaranteeing maximum possible accuracy, the information contained herein may not cover all the details and any technical-commercial modifications introduced after printing, or may describe features that are not present.